



1.5 m
Reference Listening Position

DJ position
Sweet Spot

DJ stage
Concert Level Area

2.0
Audio Format

> 117 dB
Peak Sound Level

24,000 W
Output Power

Ibiza tops the list of legendary locations to experience dancefloor euphoria with the world's top DJ talent. This same spirit rules our Ibiza 2.0 offering. Ibiza 2.0 comprises six Kara II loudspeakers and four SB18 compact subs, with over 24,000 W providing up to 142 dB of SPL (Sound Pressure Level). Clarity and performance have made Kara a perpetual best-seller and top-of-rider favorite for live events. The addition of L-Acoustics pioneering Panflex™ technology in the newest generation of Kara, Kara II, enhances precision and directivity, reinforcing the pro audio superstar status of Ibiza 2.0.

Ibiza sightings range from state-of-the-art superclubs to planetary electronic music pilgrimages. The distinctive K-shaped silhouette of Kara is clearly visible as the monitor setup for headline talent on festival mainstages. As for the all-important low frequencies, Ibiza's powerful SB18 subwoofers, four in all, put the bass in all the right places. If you and your friends are keen to play hard and party like a pro with the DJ toolkit of choice, then Ibiza beckons.

APPLICATIONS



Ibiza 2.0 will perform best as a DJ monitor system or as main system on stage. Connect your playback devices or your DJ mixer seamlessly to Ibiza 2.0 and enjoy your preferred audio content.

GENERAL SPECIFICATIONS

Audio system performance

Peak sound level	> 117 dB	Peak SPL unweighted at sweet spot using pink noise with 12 dB crest factor
Frequency bandwidth	20 Hz - 20 kHz	Range of frequencies within 10 dB of HF plateau, calibrated by factory preset
Frequency contour	+15 dB @ 40 Hz	Flat above pivot point and +5 dB/octave slope below, according to L-Acoustics sonic signature
Output power	24,000 W	RMS power delivered by 2 LA12X via 4 channels of amplification each

Technology

Loudspeaker technology	Wavefront Sculpture Technology	Line source transducer arrangement for DJ monitor applications
Loudspeaker transducer	2 x 8" LF + 1 x 3" HF	LF neodymium cone drivers. HF compression driver loaded by a DOSC waveguide
Loudspeaker directivity	V: adjustable H: 70°/110°	At -6 dB from on-axis response, averaged over 1 - 10 kHz range
Subwoofer technology	Laminar vented enclosure	L-Acoustics low-turbulence progressive vent design
Subwoofer transducer	1 x 18"	High-power neodymium transducers with high excursion

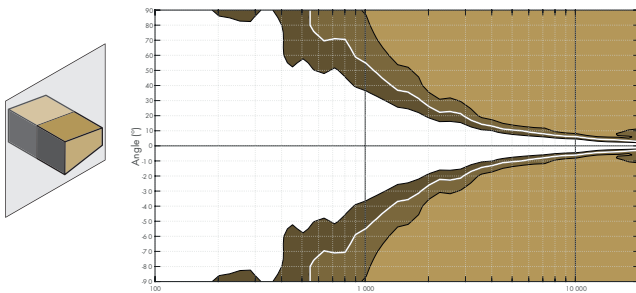

Loudspeaker directivity in vertical plane using lines of equal sound pressure at -3 dB, -6 dB, -12 dB.

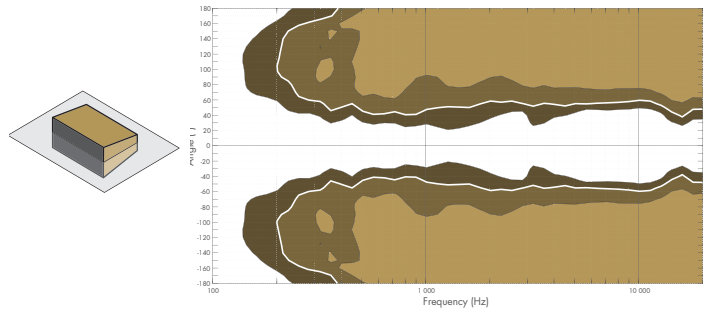

Loudspeaker directivity (using the 110° setting) in horizontal plane using lines of equal sound pressure at -3 dB, -6 dB, -12 dB.

Listening space

Reference listening position	1.5 m	Equivalent to the mixing engineer position with concert-like full dynamics and SPL levels reaching more than 105 dB SPL A weighted ¹
Sweet spot	DJ position	Area of spatialization and full stereophony equivalent to the mixing area at a concert
Concert level area	DJ area	Area defined by the system coverage in which nominal SPL can exceed 90 dB SPL A-weighted

¹ Beware of sound levels. Loudspeaker systems are capable of producing very high sound pressure levels which can lead to hearing damage.

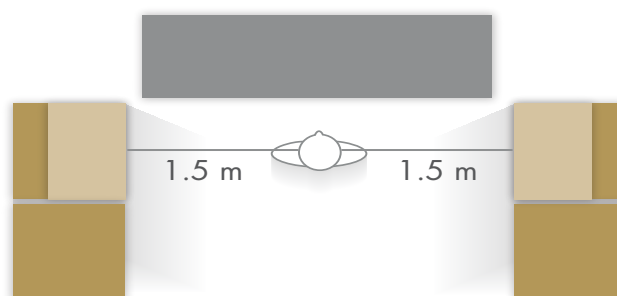

Reference listening position

Coverage

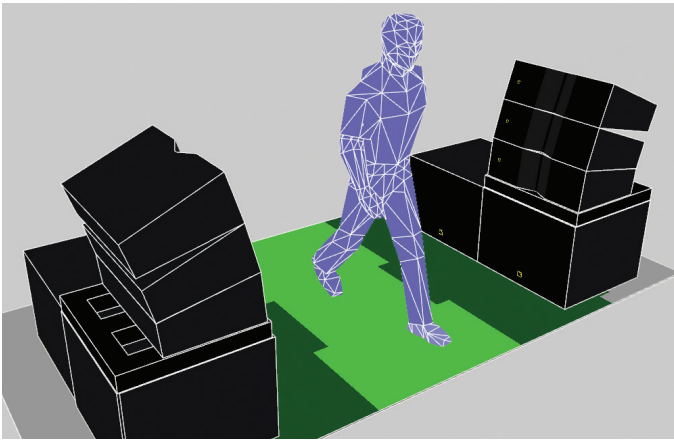

■ Sweet spot: spatialized zone mapping modeled in L-Acoustics Soundvision software represented by the central light green area

SPL (dBA)

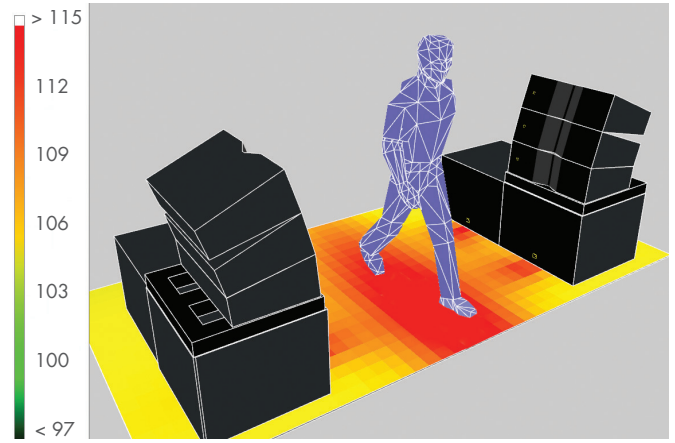

Concert level area: SPL (Sound Pressure Level) mapping modeled in L-Acoustics Soundvision software

COMPONENTS AND SYSTEM DIAGRAM

Ibiza 2.0 includes amplified controllers with integrated signal processing, loudspeakers, signal and loudspeaker cables, and accessories for integration.

Audio content is delivered through a front-end system – which is not included in Ibiza 2.0 – such as a hi-res music streamer, an AV receiver or a DJ mixer. Refer to the *Recommended front-end system* document available on the L-Acoustics Creations website for the device that best suits your application.

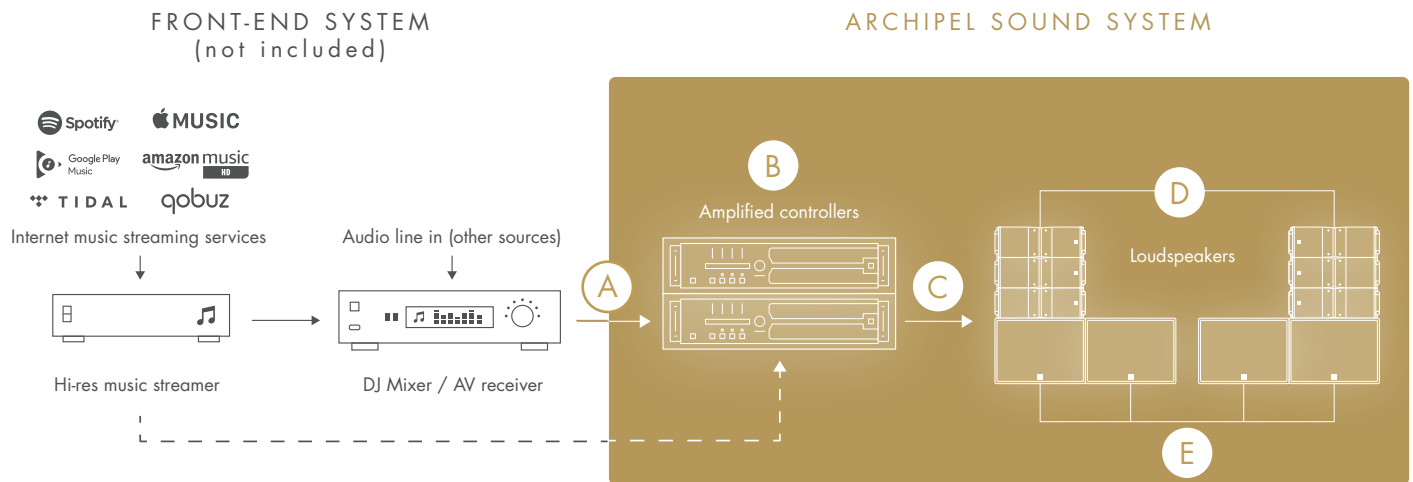

A	Signal cables	1 × RCA-XLR2: RCA to 1 × XLRM (2 m)	1 × XLR2: XLR AES (2 m)	1 × XLR0.5: XLR AES (0.5 m)
B	Amplification and processing	2 × LA12X class D four-channel amplified controllers, with cases		
C	Speaker cables	2 × DO10 10 m + DO3WFILL 3.5 m (4mm ² gauge)	4 × SP.7: 4 × 4 mm ² , speakON connectors (0.7 m)	
D	Full range loudspeakers	6 × Kara II 2-way active WST loudspeakers: 2 × 8" LF + 1 × 3" HF diaphragm with rigging platform		
E	Subwoofers	4 × SB18 high-power compact subwoofer: 1 × 18" LF	4 × SB18 dollies	

For detailed connection diagram and installation procedure, please refer to the Setup guide.

ARCHITECTURAL SPECIFICATIONS

Dimensions and weights

Kara II

Weight (net) 26 kg / 57 lb

IP Rating 55

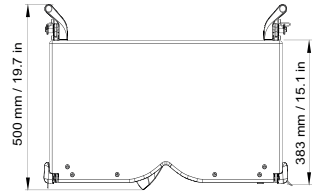
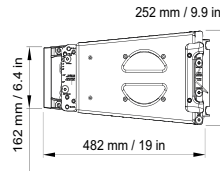
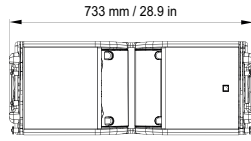

M-Bump

Weight (net) 25 kg / 55 lb

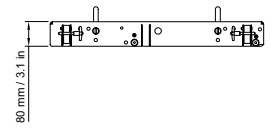
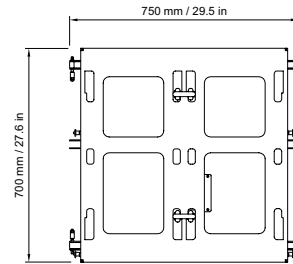

SB18

Weight (net) 52 kg / 115 lb

IP Rating 55

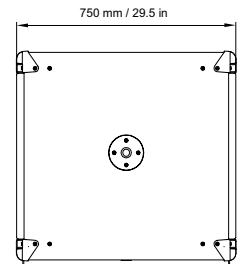
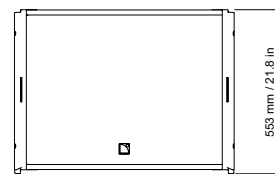
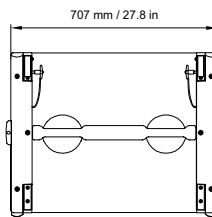

LA12X with case

Weight (net) 19.8 kg / 44 lb

IP Rating 2x

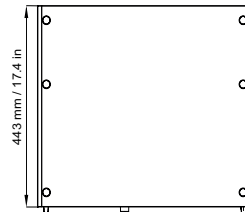
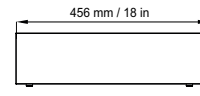
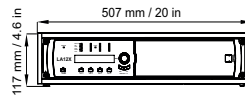

FINISHES

The Kara II and SB18 cabinets are made of premium grade Baltic birch plywood, protected with a bi-component hard coating for indoor and outdoor use. The loudspeakers exist in a Dark Grey Brown exterior finish.



Dark Grey Brown